

## Reece Safety Products Ltd

Unit B9, Lowfields Close, Lowfields Business Park, Elland, West Yorkshire HX5 9DX  
 Tel: 01422 310456 Fax: 01422 311070 Email sales@reecesafety.co.uk www.reecesafety.co.uk



### Product Information and Assembly Instructions - Universal Valve Lockout BS13/13A/14/14A/15

The Universal Lockout is a modular construction where the user can add various accessories to make the device suitable for a range of valves. Simply disassemble the device (as shown in picture) and slot in the relevant accessory.

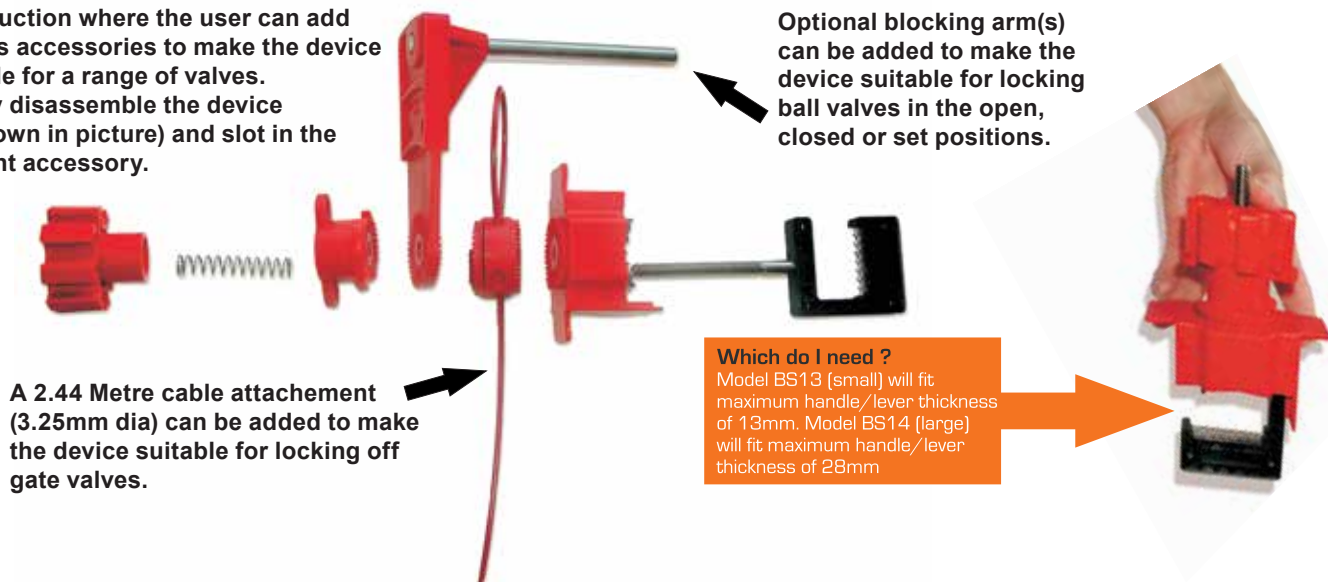

Optional blocking arm(s) can be added to make the device suitable for locking ball valves in the open, closed or set positions.

A 2.44 Metre cable attachment (3.25mm dia) can be added to make the device suitable for locking off gate valves.

**Which do I need ?**  
 Model BS13 (small) will fit maximum handle/lever thickness of 13mm. Model BS14 (large) will fit maximum handle/lever thickness of 28mm

#### Installation procedure:



1) The base unit provides a locking mechanism for locking the device to many plant structures such as valve hand wheels and levers. Compress the device to open the clamping jaws to fit. Use as a stand alone unit to lock butterfly valves



2) Add an extension arm to the clamping unit to lock 1/4 turn ball valves.



3) Add the cable attachment to the base unit to lock ball valves / gate valves, (upto two extension arms can also be used).



4) Once the device is fitted, tighten the handwheel to secure the device in place.



5) Use a padlock to lock the hand wheel to the locking point as shown to secure in place. Test the device is secure and the valve cannot be operated

